

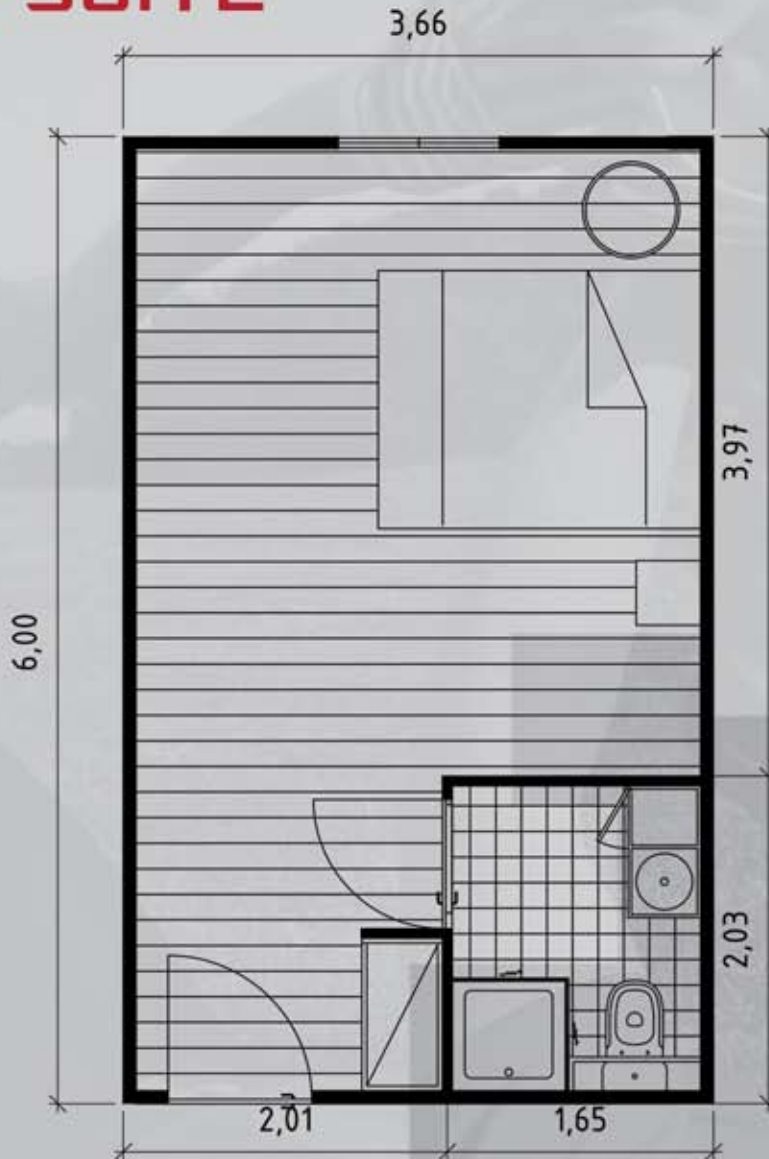

## INDUSTRY SUITE



### COMPOSITION

SUITE . 17m<sup>2</sup>

WC . 3m<sup>2</sup>

GROSS AREA . 22m<sup>2</sup>

### FINISHING:

#### WALLS

- INTERIORS COVERED WITH PLASTERBOARD PAINTED IN WHITE
- WC COVERED IN TILE
- EXTERIORS PAINTED IN SAND PAINT

#### CEILINGS

- CEILING IN PAINTED PLASTERBOARD

#### FLOOR

- PAVEMENT IN LAMINATE WOOD FLOOR
- SKIRTING BOARD IN WHITE PVC

### EQUIPMENT:

#### WC:

- SANITARY APPLIANCES (TOILET, SINK, SHOWER BASE WITH A COVER)
- BLENDING FAUCETS
- WATER HEATING SYSTEM

#### BEDROOM:

- WOODEN CLOSET WITH RUNNING DOORS

### INFRASTRUCTURES:

#### ELECTRICITY:

- CIRCUITS OF ELECTRIC SOCKETS AND LIGHTING INCLUDING ELECTRIC BOARD, ELECTRIC SOCKETS AND SWITCHES

#### PLUMBING SYSTEM:

- PLUMBING FOR HOT AND COLD WATERS
- PLUMBING FOR DOMESTIC WASTEWATER

#### ACCLIMATIZATION:

- INSTALLATION OF THE AC WITH SPLIT TYPE MACHINE